



**LOTUS RESORT & SPA**  
*Siem Reap's Premier Boutique Resort*

Resort's rating: ★★★★★

**Contact Details:**

National Highway No.6, Phum Kruos, Khum Svay Dangcum  
Siem Reap, Kingdom of Cambodia  
KH-1700  
Telephone: +855 63 965 555  
Facsimile: +855 63 965 556  
Email: [info@lotusangkor.com](mailto:info@lotusangkor.com)  
Website: [www.lotusangkor.com](http://www.lotusangkor.com)

Tel: +855 63 965 555 Ext. 8812  
Mobile: +855 12 230 100  
Email: [reservation@lotusangkor.com](mailto:reservation@lotusangkor.com)

**Sales & Marketing Contact Details:**

Tel: +855 63 965 555 Ext. 8813  
Mobile: +855 17 626 241  
Email: [sales@lotusangkor.com](mailto:sales@lotusangkor.com)



**Brief Description:** Large area-compound with beautiful landscape gardens and surrounded by a tree-lined tropical space. A resort feeling you will received, starting from the time of your arrive until the whole period of your stay. Inspired by today's needs, the resort has its own conventional Khmer theme decoration and handmade traditional style furniture.

**General Manager:** Mrs. Verey Nhim

### Distance and Measurements:

Resort's Total Land Size	:	12,036 square meters
Distance from Siem Reap National Airport	:	7 kilometers
Distance from the nearest shopping center	:	100 meters (opposite the road)
Distance from the nearest bank or ATM	:	500 meters
Distance from the nearest hospital	:	2 kilometers
Distance from the Angkor Wat Temple	:	8 kilometers
Distance from the nearest museum	:	1 kilometer
Distance from the nearest restaurant with show	:	1 kilometer

### Transportation:

Travelling time from/to Airport	:	12 minutes
Travelling time from/to Downtown	:	10 minutes
Travelling time from/to Angkor Wat	:	15 minutes
Available Vehicle for Travelling	:	Car, Van, Bus or Remork (tuk-tuk)

### Check In and Check Out

Standard Check-In Time	:	2:00pm or 1400hrs
Standard Check-Out Time	:	12:00pm or 1200hrs

### Accepted Credit Cards

Credit Card Brand	:	Visa Card, Master Card and JCB Card
-------------------	---	-------------------------------------

### Communication:

Foreign Languages Spoken within the Lotus : English, French, Mandarin, Filipino and Thai

### Services & Facilities:

- 24 Hours Security
- Nanny / Baby Sitter
- Souvenir Shop
- Business Center
- Car Rental Services (w/ driver)
- Conference / Meeting Room
- Concierge
- Currency Exchange
- Doctor on Call
- Dry Cleaning Services
- Fire & Emergency Tools
- Emergency Service Stairs
- Elevators
- Free Car Parking
- Guest Relations Services
- Internet Service (Wifi)
- Luggage Storage Facility
- Express and Normal Laundry
- 24 Hours Reception Counter
- Safety Deposit Box (in-room & reception counter)
- Secretarial Services
- Waiting Room
- Handicapped Room
- Hot Water & Air-conditioned guest rooms

### Recreational Facilities:

- Swimming Pool (Length: 25m Width: 12.50m Depth: 1.50m)
- Children's Pool
- Spa / Massage Rooms
- Pool Bar
- Health & Fitness Center
- Herbal Steam Room

## Food & Beverage Services:



### Brief Description:

Craving for something exquisite? Try our Royal Khmer Cuisine and you will surely know and determine the food fit for the King of Khmer Empire. Our well trained Chef will surely transport you to another dimension satisfying not only your stomach but also your knowledge of what Khmer food is all about. We also do serve European and Western cuisine

<b>Outlet Name</b>	:	<b>Lotus Pond Restaurant &amp; Bar</b>
Concept	:	Asian and Western Dining
Operation Hours	:	0600hrs until 2200hrs
Breakfast	:	0600hrs until 100hrs
Lunch	:	1130hrs until 1430hrs
Dinner	:	1830hrs until 2200hrs
Seating Capacity	:	100

<b>Outlet Name</b>	:	<b>Patio</b>
Concept	:	Out Door Fine or BBQ Dining (good for mini outdoor events)
Operation Hours	:	1830hrs until 2200hrs
Dinner	:	1830hrs until 2200hrs
Seating Capacity	:	35

<b>Outlet Name</b>	:	<b>Pool Bar (Swimming pool area)</b>
Concept	:	Pool Side dining & drinking (good for big events)
Operation Hours	:	0600hrs until 2200hrs
Seating Capacity	:	150

<b>Outlet Name</b>	:	<b>Lotus Lobby Bar</b>
Concept	:	Cocktails, Snack & All kind of drinks
Operation Hours	:	0900hrs until 2300hrs
Seating Capacity	:	30

<b>Outlet Name</b>	:	<b>Room Service</b>
Operation Hours	:	24 hours



## Accommodation:

Brief Description : Our 101 skillfully decorated guestrooms are divided into 4 categories; Deluxe, Executive, Family and Suite Rooms. All rooms have undergone extensive research and development to cater present traveler needs in terms of accommodation.

Deluxe Room	:	63 Rooms
Executive Room	:	23 Rooms
Elegant Suite Room	:	8 Rooms
Family Suite Room	:	6 Rooms
Classic Suite Room	:	1 Room

---

Total Number of rooms : **101 Rooms**

## Room Amenities (all room types):

- Soft mattress sofa & stool
- Cotton Bathrobes
- Bathroom amenities
- Bath-tub with hot & cold shower
- Coffee/tea making facility
- Smoke detector
- Scale (on request)
- Electronic Safe
- Hair Dryer
- Umbrella (on request)
- Double Lock Door
- Baby Cot (on request)
- Coffee Table
- IDD Telephone
- Manual Air-conditioned controller
- Iron board (on request)
- Color Cable TV with remote control
- Phone extension in bathroom
- Mirrors
- Disposable Slippers
- Stocked Mini-bar
- Toilet
- Working Desk with Stationery
- Non-carpeted Wooden Floor
- Roll away bed (on request)
- Lamp Shades

## Deluxe Rooms



### Description:

Spacious room with unique traditional Khmer design. Majority of the deluxe rooms overlook the tropical garden of the resort

<b>Number of rooms</b>	: 63
<b>Average room sizes (excluding terrace)</b>	: 32 sq.m.
<b>Numbers of Extra bed allowed</b>	: 1
<b>Maximum number of people allowed</b>	: 3

### In-Room Amenities:

- Teak Wood floor finish
- Cable television with remote control
- Touch button IDD telephone
- Free broadband internet access in every room
- In-room internet cable and electricity adopter (220V)
- Complimentary coffee / tea making facility
- Complimentary two bottles of drinking water per day
- Private balcony for all the room
- Guestroom amenities
- Writing table
- Personal in-room electronic safe
- Bathroom with bath-tub and standing hot and cold water shower
- Hair dryer
- Bathrobe
- Slippers
- Full-Length Mirror
- Air-conditioning
- Mini-bar (chargeable)
- Baby-cot (baby crib) on request with complimentary use
- Iron & ironing board (on request)
- Guest service directory

### Guest Services:

24-hour personal Valet service; 24-hour room service; Valet escort to room upon check-in; Daily turn-down service; Laundry & dry cleaning service; Shoeshine service; Wake-up call service; Breakfast on Bed (on request)

## Executive Rooms



### Description:

Spacious room with unique traditional Khmer design. All rooms are inclusive of today's up to date electronic gadget to enhance your stay.

<b>Number of rooms</b>	:	23
<b>Average room size (excluding terrace)</b>	:	32 sq.m.
<b>Numbers of Extra bed allowed</b>	:	1
<b>Maximum number of people allowed</b>	:	3

### Additional Amenities:

- Rain-Shower Bathroom
- Balcony with a stunning view of the Coconut field
- WIFI access for Internet connection

### In-Room Amenities:

Teak Wood floor finish  
Flat-screen plasma cable television with remote control  
Touch button IDD telephone  
Internet access in every room  
In-room internet cable and electricity adopter (220V)  
Complimentary coffee / tea making facility  
Complimentary two bottles of drinking water per day  
Private balcony for all the room  
Guestroom amenities  
Writing table  
Personal in-room electronic safe  
Bathroom with standing hot and cold water shower  
Hair dryer  
Bathrobe  
Slippers  
Full-Length Mirror  
Air-conditioning  
Mini-bar (chargeable)  
Baby-cot (baby crib) on request with complimentary use  
Iron & ironing board (on request)  
Guest service directory

### Guest Services:

24-hour personal Valet service; 24-hour room service; Valet escort to room upon check-in; Daily turn-down service; Laundry & dry cleaning service; Shoeshine service; Wake-up call service; Breakfast on Bed (on request)

## Family Suite Rooms



### Description:

Siem Reap's first of its kind spacious room with unique traditional Khmer design with a touch of modern amenities plus other value-added services all for the comfort of the traveling families. All of our family suite-rooms overlook the tropical pool garden of the Resort.

<b>Number of rooms</b>	:	6
<b>Average room size (excluding terrace)</b>	:	55 sq.m.
<b>Numbers of Extra bed allowed</b>	:	2
<b>Maximum number of person allowed</b>	:	5

### Additional Amenities:

- Separate living room
- A choice of with or without Balcony with a stunning view of the Coconut field
- WIFI/DSL access for Internet connection
- Assorted bucket of toys
- Mini-bar filled with kiddy items

### In-Room Amenities:

Teak Wood floor finish  
Cable television with remote control  
Touch button IDD telephone  
In-room internet cable and electricity adopter (220V)  
Complimentary coffee / tea making facility  
Complimentary two bottles of drinking water per day  
Private balcony for all the room  
Guestroom amenities  
Writing table  
Personal in-room electronic safe  
Bathroom with bath-tub and standing hot and cold water shower  
Hair dryer  
Bathrobe  
Slippers  
Full-Length Mirror  
Air-conditioning  
Mini-bar (chargeable)  
Baby-cot (baby crib) on request with complimentary use  
Iron & ironing board (on request)  
Guest service directory

### Guest Services:

24-hour personal Valet service; 24-hour room service; Valet escort to room upon check-in; Daily turn-down service; Laundry & dry cleaning service; Shoeshine service; Wake-up call service; Breakfast on Bed (on request), Nanny Services (on request)

## Elegant Suite Rooms



### Description:

Newly refurbished two-room convergence modern designed setting. In-room amenities are pre-selected and exclusively designed to match the modern look. Located on the top floor of the building overlooking the whole resort area and the Phnom Krom on the way to the Tonle Sap Lake, this room is ideal for travelers seeking more space and privacy.

<b>Number of rooms</b>	:	8
<b>Average room size (excluding terrace)</b>	:	72 sq.m.
<b>Numbers of Extra bed allowed</b>	:	1
<b>Maximum number of person allowed</b>	:	3

### Additional Amenities:

- Separate living room
- Separate dining area
- Separate Toilet for the guests
- WIFI/DSL access for Internet connection
- Master bathroom

### In-Room Amenities:

- Teak Wood floor finish
- Separate living room furnish with Sofa, Flat-screen plasma cable television with remote control, air-condition with climate control, big writing table and guest toilet
- Separate bedroom with living room, writing table, air-condition with climate control and view of Phnom Krom
- Touch button IDD telephone
- Internet access in-room
- In-room internet cable and electricity adopter (220V)
- Complimentary coffee / tea making facility
- Complimentary two bottles of drinking water per day
- Private balcony and view of Phnom Krom
- Guestroom amenities
- Personal in-room electronic safe
- Private Bathroom with separate bath-tub and standing hot and cold water shower
- Hair dryer
- Bathrobe
- Slippers
- Full-Length Mirror
- Air-conditioning
- Mini-bar (chargeable)
- Baby-cot (baby crib) on request with complimentary use
- Iron & ironing board (on request)
- Guest service directory

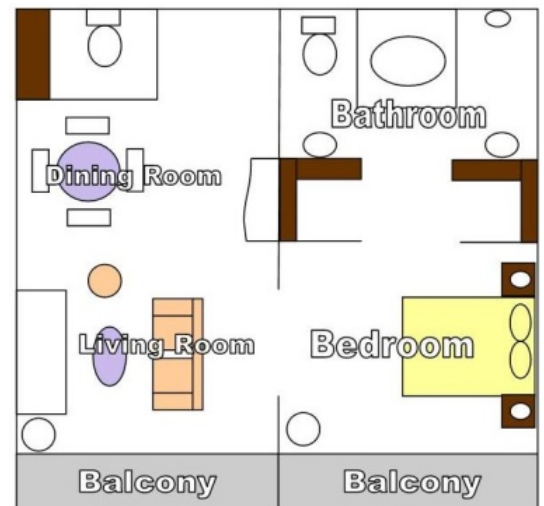

### Guest Services:

24-hour personal Valet service; 24-hour room service; Valet escort to room upon check-in; Daily turn-down service; Laundry & dry cleaning service; Shoeshine service; Wake-up call service; Breakfast-on-Bed (on request), Personal butler or secretary (on request), Nanny services (on request)

## Classic Suite Room



### Description:

Newly refurbished two-room convergence designed in a colonial-antique setting. In-room amenities are pre-selected and exclusively designed to match the classic modern look-ambiance of the past Cambodian era dating back before the Khmer Rouge time. This room is perfect for discerning travelers seeking for adventure.

<b>Number of rooms</b>	:	1	<b>Additional Amenities:</b>
<b>Average room size (excluding terrace)</b>	:	72 sq.m.	- Separate living room
<b>Numbers of Extra bed allowed</b>	:	1	- WIFI/DSL access for Internet connection
<b>Maximum number of people allowed</b>	:	3	- Master bathroom

### In-Room Amenities:

Teak Wood floor finish  
Separate living room furnish with Sofa, cable television with remote control, air-condition with climate control, big writing table  
Separate bedroom with living room, writing table, air-condition with climate control and view of Bakheng Mountain  
Touch button IDD telephone  
Internet access in-room  
In-room internet cable and electricity adopter (220V)  
Complimentary coffee / tea making facility  
Complimentary two bottles of drinking water per day  
Private balcony and view of Bakheng Mountain  
Guestroom amenities  
Personal in-room electronic safe  
Bathroom with separate bath-tub and standing hot and cold water shower  
Hair dryer  
Bathrobe  
Slippers  
Full-Length Mirror  
Air-conditioning  
Mini-bar (chargeable)  
Baby-cot (baby crib) on request with complimentary use  
Iron & ironing board (on request)  
Guest service directory

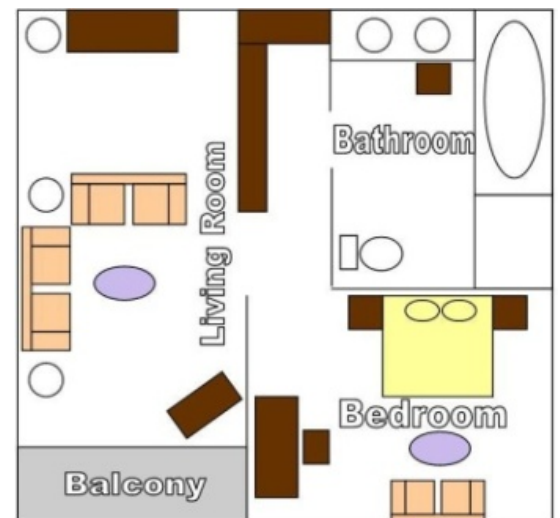

### Guest Services:

24-hour personal Valet service; 24-hour room service; Valet escort to room upon check-in; Daily turn-down service; Laundry & dry cleaning service; Shoeshine service; Wake-up call service; Breakfast on Bed (on request)

## Conference Room

<b>Number of rooms</b>	:	1
<b>Room Name</b>	:	Boardroom
<b>Average room size (excluding terrace)</b>	:	Side A: Length: 9.10m Width: 6.10m Height: 2.8m
	:	Side B: Length: 8.56m Width: 4.90m Height: 2.8m
<b>Maximum number of people allowed</b>	:	45
<b>Location</b>	:	1st Floor

### Our meeting room's basic features:

- LCD Projector with Mobile Screen
- Audio / Video System
- Microphone or Wireless Microphone
- Sound & Light controller
- Air Conditioner with Remote Control
- Near to guest rooms
- Near to the Service Stairs
- VCR / VCD / DVD Player
- Flip Chart & White Board
- Mobile Podium
- Meeting Recorder
- Extra Space for Secretary or Equipments
- Space for Back draft
- Near to the Elevator

### Applicable Set-Up Style:

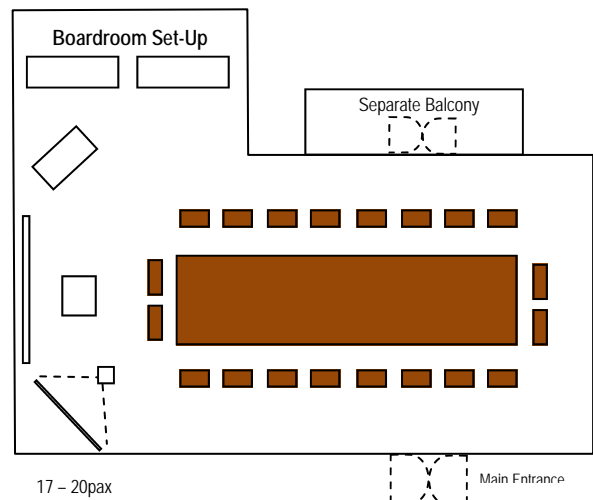
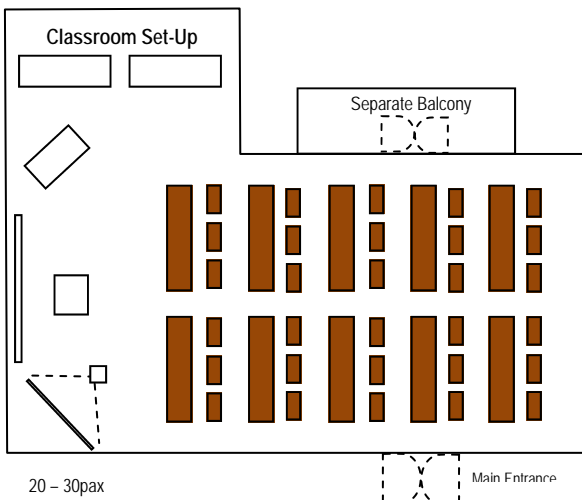
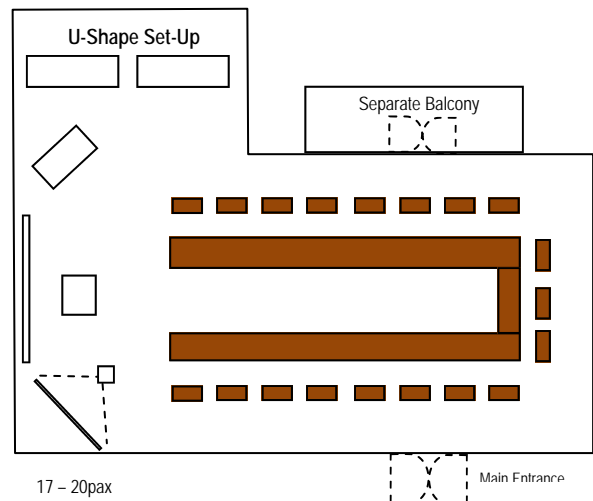
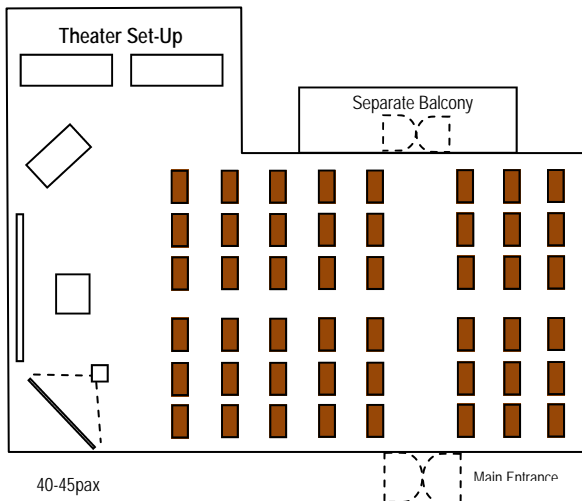

## Spa Wellness Treatment



Sabay Spa offers different kind of aroma and therapeutic spa treatments that pampers not only the body but also mind, day or night. Chose your location for treatment whether it is in-door or out-door. Our highly-trained resident therapists will guide you through the rest of the treatment to revive those aching muscles.

<b>Number of rooms</b>	: 2 In-door
<b>Average room sizes (excluding terrace)</b>	: 32 sq.m.
<b>Numbers of bed inside</b>	: 2
<b>Maximum number of people allowed</b>	: 2
<b>Type of Treatment</b>	: Cambodian (Asian)

## Fitness & Pool Center

After a day of sightseeing tour to the temples or around Siem Reap, unwind and relax in our swimming pool, Siem Reap's famous lap-pool or visit our fully equipped gymnasium to stretch out those tired muscles but if you are looking for something different, join our yoga sessions under the coconut field.



<b>Number of rooms</b>	: 1 In-door
<b>Average room sizes (excluding terrace)</b>	: 38 sq.m.
<b>Maximum number of people allowed</b>	: 10



<b>Number of pool</b>	: 1 Out-door
<b>Pool measurement</b>	: 25m x 15m x 1.5m

## M.I.C.E Arrangements

### Private Corporate Luncheons or Gala Dinner:

Our poolside Area that can cater more than 250 people is the perfect place for you! Good for special corporate gala-dinner, birthday party-functions, incentive groups, product launching events - Spacious, comfy & filled with professional event and catering organizer.

### Other Theme Packages as follows:

- Circus Theme Dinner (out-door preferred)
- Market Theme Dinner (out-door preferred)
- Masquerade Theme Dinner (out-door preferred)



- Khmer Theme Dinner with traditional show

### Team Building Packages:

Team building now-a-days is a major part of company's must have investment. It is a need on where it involves strengthening the human relations among co-workers between simple ranking staffs and their superiors. Not only it plays an integral part of company's growth, it also helps deepening the relationship between co-workers and the community they live in.

Here at Lotus Resort & Spa, we believe in Team Building that is why we have created numerous Team Building exercises matching each company's allocated budget.

For more information with regards to how we can cater your Team Building needs here in Siem Reap, please do not hesitate to get in-touch with us.

